

OKERMAN SURVEYING

Registered Land Surveyors

CERTIFICATE OF SURVEY

For FIRST FEDERAL SAVINGS AND LOAN ASSOCIATION



Scale 1" = 30'

DESCRIPTION:

Lots One (1), Two (2), Three (3), and Four (4), of Block Two (2), of Bagley, according to the plat on file and of record in the office of the Register of Deeds, Clearwater Co., Minnesota.

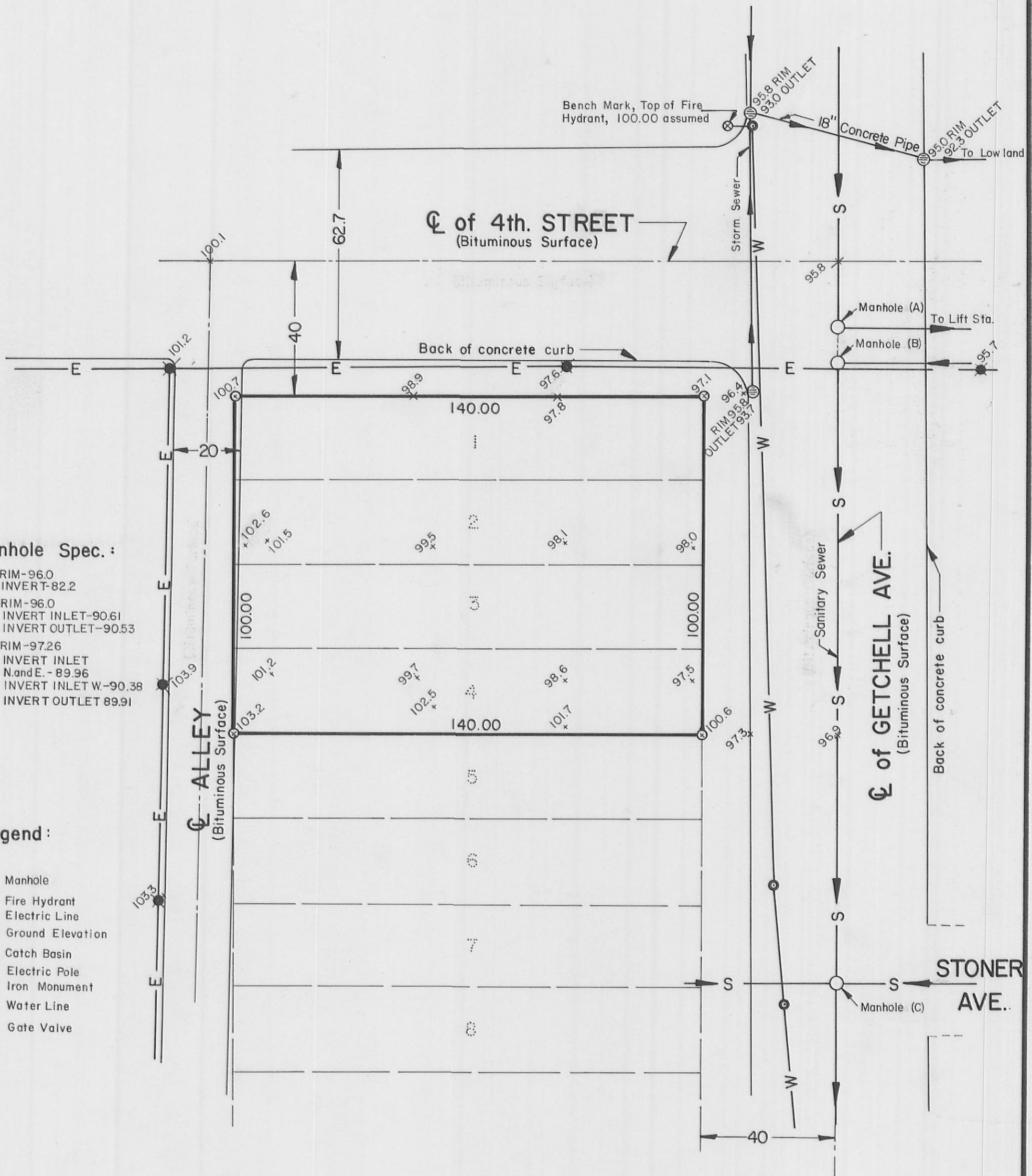

Manhole Spec. :

- A. RIM-96.0
INVERT-82.2
- B. RIM-96.0
INVERT INLET-90.61
INVERT OUTLET-90.53
- C. RIM-97.26
INVERT INLET
N. and E. - 89.96
INVERT INLET W.-90.38
INVERT OUTLET 89.91

Legend :

- Manhole
- ⊗ Fire Hydrant
- E- Electric Line
- 100.0 Ground Elevation
- ⊕ Catch Basin
- Electric Pole
- Iron Monument
- W- Water Line
- ⊙ Gate Valve

I hereby certify that this is a true and correct representation of a survey of the boundaries of the land described above. It does not purport to show improvements or encroachments, if any. As surveyed by me this 8th day of July, 1976.

by William D. Okerman